



THE BOULOS
COMPANY

FOR LEASE

100 TRI CITY ROAD
SOMERSWORTH, NH



INTRODUCTION

Small industrial units available in this newly constructed industrial building. Conveniently situated just off Exit 9 of the Spaulding Turnpike, offering excellent accessibility and easy connections to major transportation routes.

PROPERTY DETAILS

- Available units ranging in size from 1,664± SF to 4,041± SF
- HVAC, 200 AMP electrical service, an ADA compliant bathroom, a 14' x 14' overhead door and 100± SF of office space
- Ceiling heights ranging from 14' - 19' depending on unit
- Units are individually metered for electric and HVAC
- LEASE RATE: \$14.00 - \$14.50/SF Modified Gross. Tenant pays heat and electric directly.

CONTACT US



KENT WHITE
PRINCIPAL BROKER, PARTNER
+1 603 570 2699 T
+1 603 781 6546 C
KWHITE@BOULOS.COM



AUSTIN STEBBINS
ASSOCIATE
+1 603 570 2692 T
+1 207 530 0022 C
ASTEBBINS@BOULOS.COM



Example Warehouse/Drive-in Door



Example Office



Example Warehouse

SPECIFICATIONS

BUILDING SIZE:	52,138± SF
AVAILABLE SPACE:	Unit 111: 1,664± SF Unit 117: 4, 041± SF Unit 118: 3,892± SF
AVAILABLE:	Immediately
LAND AREA:	5.03± AC
ZONING:	Business: Multiple permitted uses including but not limited to: industrial, commercial, and retail
CONSTRUCTION:	Masonry and steel with partial brick veneer; metal panel facade
FLOORING:	6 inch slab
ROOF:	Flat tar and gravel
YEAR BUILT/RENOVATED:	1970/2020
UTILITIES:	City water, sewer, and natural gas
HVAC: ALL UNITS	Warehouse: modine heater Office: mini split with heat and air conditioning Bathroom: electric heater
ELECTRIC SERVICE:	200 Amp, 208 Volts, 3-Phase
SPRINKLERS:	Wet system
CEILING HEIGHTS:	14' - 19'
PARKING:	Negotiable
ADDITIONAL TENANT EXPENSES:	Tenant is responsible for heat and electric which are separately metered, and trash and dumpster expense.
LEASE RATE:	Unit 111: \$14.50/SF MG Units 117 & 118: \$14.00/SF MG

FLOOR PLAN

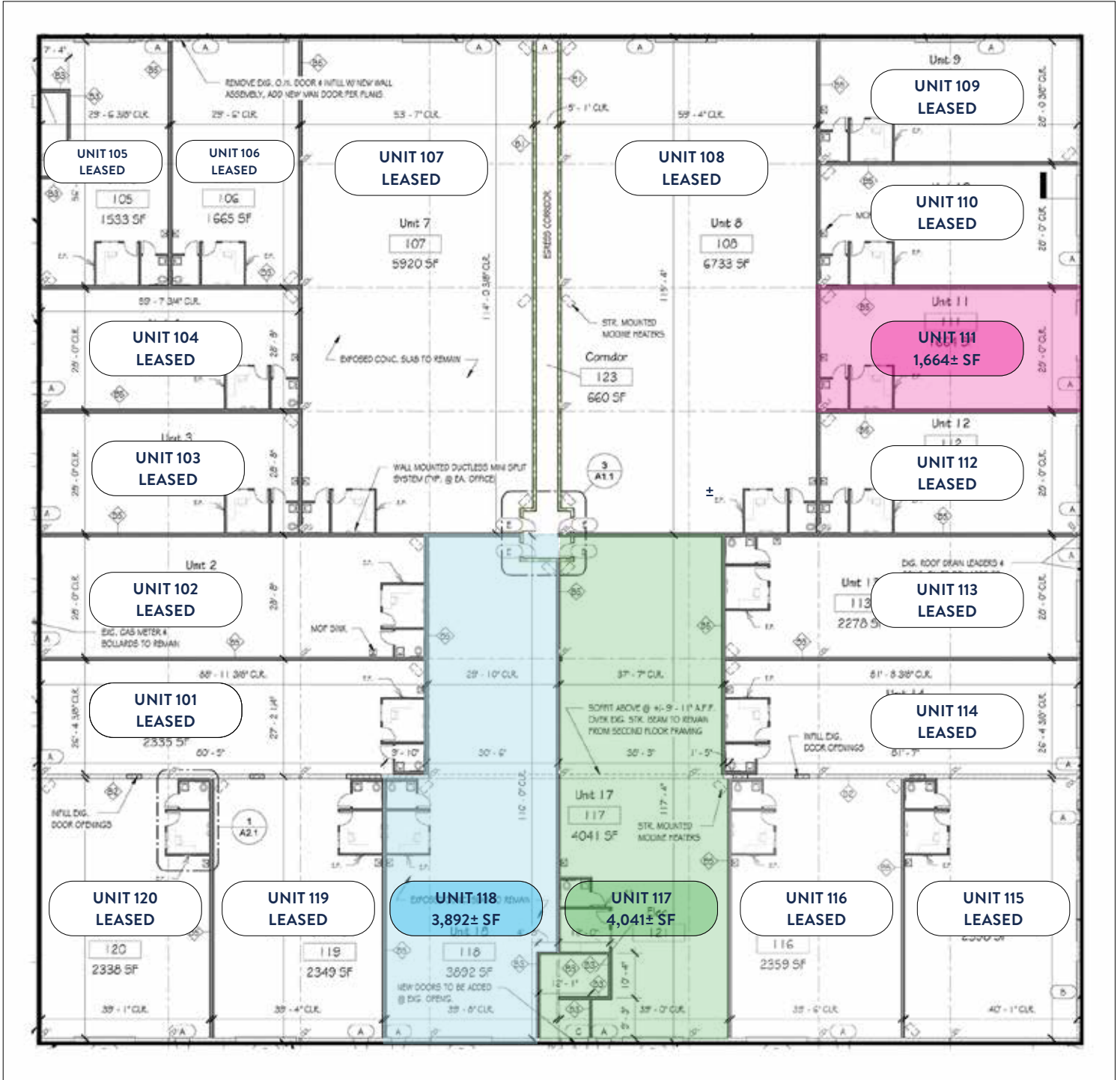

Floor plans are for illustrative purposes only, are not to scale and should be viewed with this in mind and used as a guide only.



AREA DESCRIPTION

Somersworth, New Hampshire is located in the Seacoast region of New Hampshire and is a part of the Greater Dover area. Conveniently located an hour north of Boston and just minutes from historic Portsmouth NH, Somersworth is a great choice for companies looking to start or expand their business. The city government is committed to fostering a business friendly environment and offers a variety of resources and incentives to help businesses succeed. Somersworth is home to a variety of businesses, including marks displayed, healthcare, retail, and hospitality. The city is well-connected to the rest of the region and to major transportation hubs, making it a convenient place to do business.



© 2026 Boulos Holdings, LLC, d/b/a The Boulos Company. All rights reserved. This information has been obtained from sources believed reliable, but has not been verified for accuracy or completeness. You should conduct a careful, independent investigation of the property and verify all information. Any reliance on this information is solely at your own risk. The Boulos Company and the The Boulos Company logo are service marks of The Boulos Company, Inc. and Boulos Holdings, LLC. All other marks displayed on this document are the property of their respective owners. Photos herein are the property of their respective owners. Use of these images without the express written consent of the owner is prohibited.