

**PORTA
& CO.**

FOR LEASE: INTERSTATE OFFICE

9 Gould Road, Lewiston ME 04240



Property Highlights

- 4,745± SF of turnkey executive office space
- Landlord to retain basement and yard space
- 1.2 miles from Maine Turnpike I-95 Exit 80
- Road frontage on Gould Rd., Lisbon St. (Route 196) and the Maine Turnpike
- Area businesses include: Dunkin', Boston Granite Exchange, Kullson Engineered Technologies, Al's Sports Center, Aroostook Fence Company and more
- Lease Rate: \$15.00/SF MG



PORTA & CO. | 30 Milk Street, Second Floor | Portland, ME 04101 | (207)-747-1515

www.portacompany.com

Owner	Hebert Michael R
Assessors Reference	Map 069, Lot 017
Lot Size	1.22± acres
Available Space: First Floor	4,745± SF
Book & Page	8906 & 163
Parking	Ample on-site paved parking
Utilities	Municipal water/sewer, natural gas
Zoning	Highway Business District (HB)
HVAC	Forced hot air and AC
Lease Rate:	\$15.00/SF MG (plus prorata share utilities)



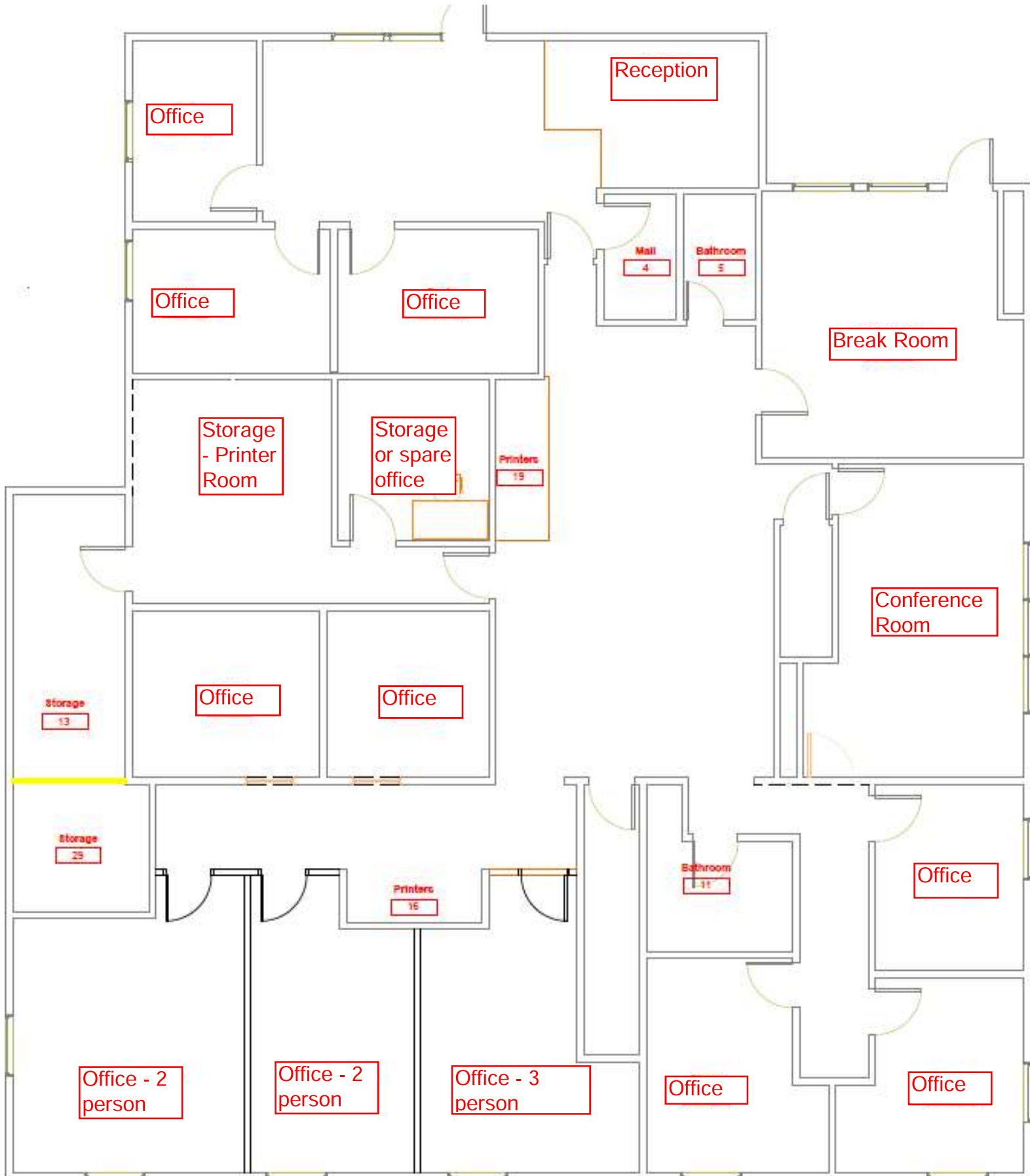

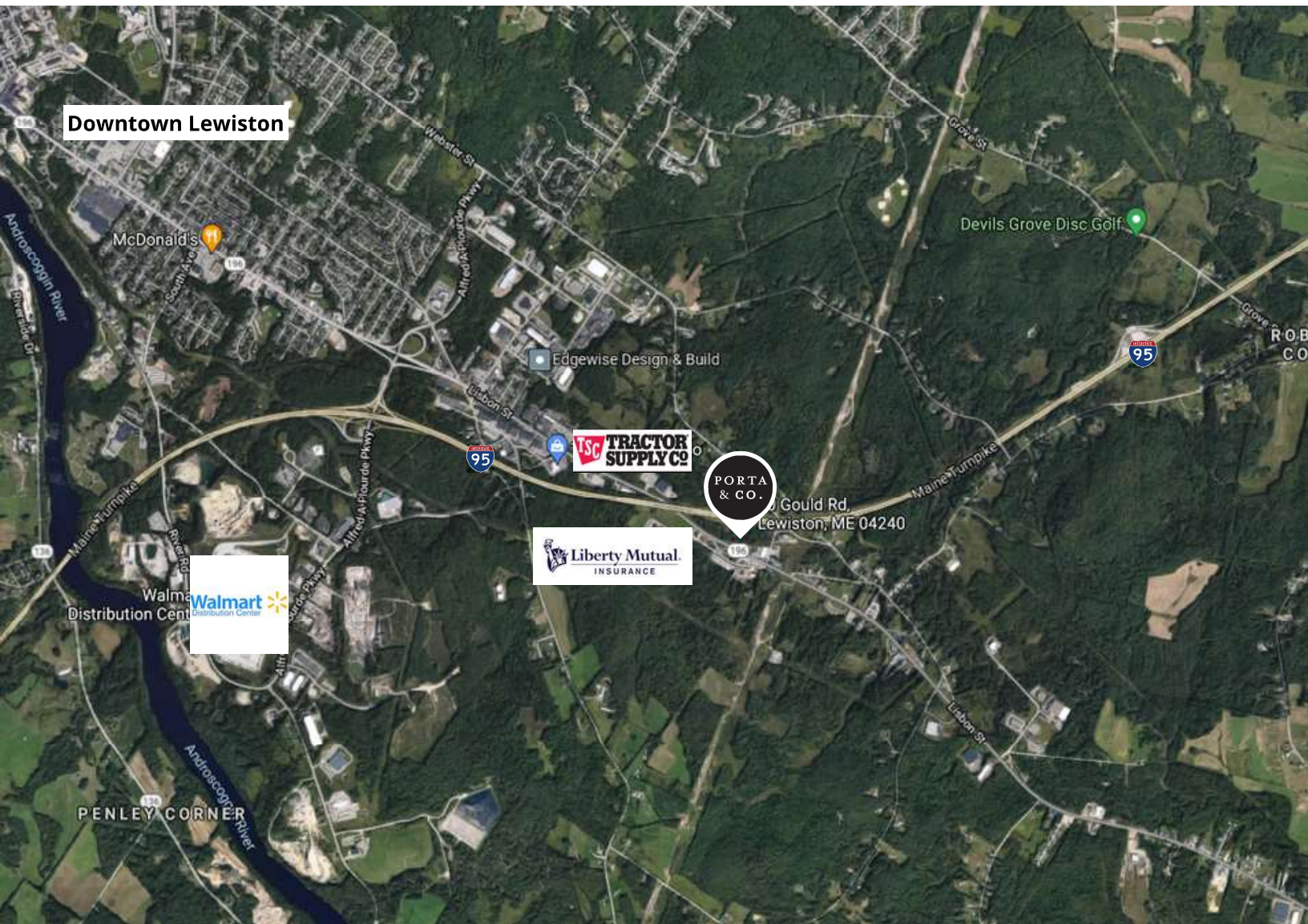

CONTACT



Tim Millett

Partner

C: 207-713-6995

O: 207-558-0893

tmillett@portacompany.com

This information has been obtained from sources believed reliable and is intended for informational use only. The information contained herein has not been verified for accuracy or completeness. It is recommended that prospective tenants and buyers conduct their own inspection of the property and verify all information. Any reliance on this information is solely at your own risk. Photos herein are the property of their respective owners. Use of these images without the express written consent of the owner is prohibited.

PORTA & CO.

COMMERCIAL REAL ESTATE

30 Milk Street, Second Floor
Portland, ME 04101
207-747-1515
www.portacompany.com