



FOR LEASE

125 JOHN ROBERTS ROAD, SUITE 18
SOUTH PORTLAND, ME 04106

INDUSTRIAL/ FLEX SPACE

PROPERTY HIGHLIGHTS

- One (1), 4,000± SF Industrial/Flex Unit
- Unit features large open warehouse space, 16' ceiling heights, one(1) overhead door, and office space
- Ample, on-site parking in common with other tenants
- Conveniently located just minutes from I-95, I-295, and the Portland International Jetport
- Available immediately
- Lease rate: \$10.00/SF NNN

FOR LEASE | INDUSTRIAL/FLEX SPACE

125 JOHN ROBERTS ROAD, SUITE 18
SOUTH PORTLAND, ME 04106



PROPERTY DETAILS

OWNER	SJ REALTY	HVAC	COMBINATION ELECTRIC & GAS
ASSESSOR'S REFERENCE	MAP 75, BLOCK A, LOT 11, BLOCK E	POWER	200 AMP, 3-PHASE
DEED REFERENCE	BOOK 5032 PAGE 295	UTILITIES	MUNICIPAL WATER/SEWER
ZONING	IL - LIGHT INDUSTRIAL	CEILING HEIGHT	16'
BUILDING SIZE	96,204± SF	GRADE LEVEL DOOR	1 PER UNIT
AVAILABLE SPACE	SUITE 18: 4,000±/SF	YEAR BUILT	1979
DATE AVAILABLE	Immediately	LEASE RATE	\$10.00/SF NNN
PARKING	ON-SITE, PAVED	EXPENSES (EST.)	TAXES: \$1.31/SF CAMS: \$2.08/SF

FLOOR PLAN

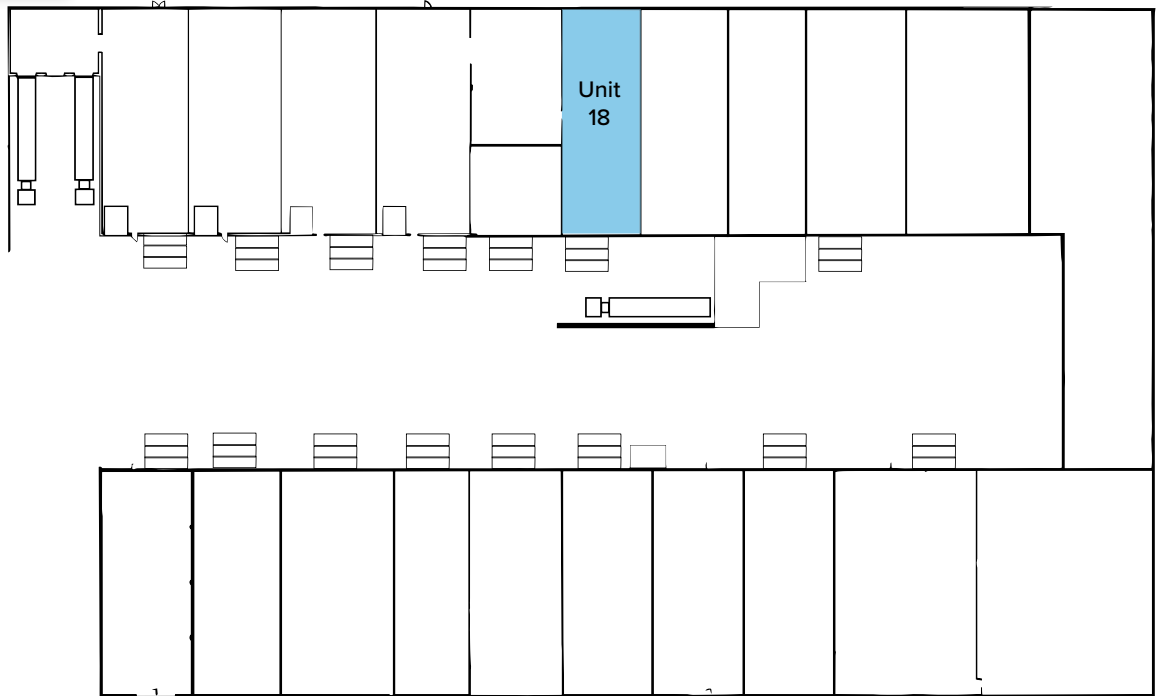

FOR LEASE | INDUSTRIAL/FLEX SPACE

125 JOHN ROBERTS ROAD, SUITE 18
SOUTH PORTLAND, ME 04106



UNIT 18



FOR LEASE | INDUSTRIAL/FLEX SPACE

125 JOHN ROBERTS ROAD, SUITE 18
SOUTH PORTLAND, ME 04106



CONTACT



JOE ITALIAANDER
Broker

207.553.1730 D
404.933.7844 C
jjitaliaander@boulos.com

©2026 The Boulos Company, Inc. All rights reserved. This information has been obtained from sources believed reliable but has not been verified for accuracy or completeness. You should conduct a careful, independent investigation of the property and verify all information. Any reliance on this information is solely at your own risk. The Boulos Company and The Boulos Company logo are service marks of The Boulos Company, Inc. All other marks displayed on this document are the property of their respective owners. Photos herein are the property of their respective owners. Use of these images without the express written consent of the owner is prohibited.