

AVAILABLE FOR LEASE

62 PEGASUS STREET

BRUNSWICK, MAINE 04011

OFFICE SPACE • 8,306 SF • SINGLE FLOOR

8,306

SQUARE FEET

\$14.00

PER SF / YEAR

NNN

LEASE TYPE

Now

AVAILABLE

PROPERTY OVERVIEW

Professional Office Space — Brunswick Landing

This move-in-ready 8,306 SF professional office space is located at 62 Pegasus Street within Brunswick Landing — one of Brunswick's premier mixed-use campuses. The space features 22+ private offices, two large conference rooms, four small group meeting rooms, a reception and waiting area, and ample on-site parking. Ideal for healthcare, government, nonprofit, or professional service tenants seeking a fully built-out, single-floor layout with convenient access to I-295 and Route 1.



Exterior



Lobby / Reception



Office Corridor

62 Pegasus Street - Brunswick, Maine 04011

SPACE HIGHLIGHTS

- 8,306 SF – single floor, move-in ready
- 22+ private offices
- 2 large conference rooms
- 4 small group / meeting rooms
- Reception and waiting area
- Ample on-site surface parking
- ADA compliant
- Professional campus environment
- Located within Brunswick Landing
- Minutes from I-295 and Route 1

LEASE INFORMATION

Building Size	8,306 SF
Lease Rate	\$14.00 / SF / Year
Lease Type	NNN
Availability	Immediate
Parking	Surface - On-Site
Floors	1
Private Offices	22+
Conference Rooms	2 Large + 4 Small
ADA	Compliant

PROPERTY DETAILS

Address	62 Pegasus Street
City / State	Brunswick, ME 04011
Campus	Brunswick Landing
Property Type	Professional Office
ADA	Compliant

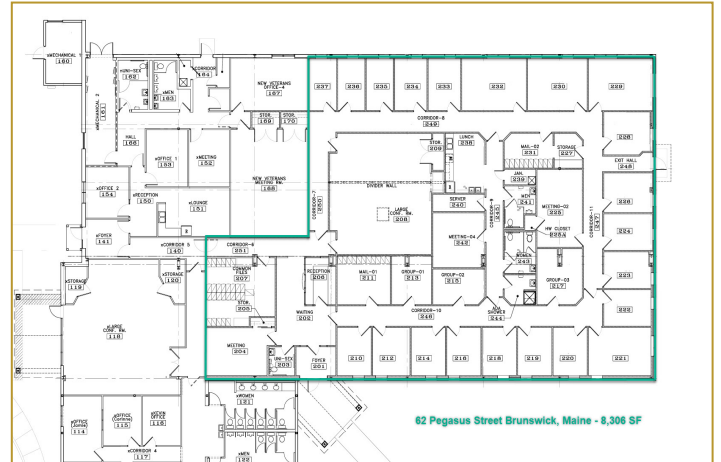

Floor Plan · 62 Pegasus Street, Brunswick, ME · 8,306 SF

LOCATION & ACCESS

- Brunswick Landing - former Brunswick Naval Air Station
- Thriving mixed-use campus with 125+ businesses
- Located just off Route 1, minutes from I-295
- Portland: 25 miles - Augusta: 40 miles
- Cook's Corner retail corridor nearby

CONTACT US

Priority Real Estate Group

Priority Business Center
2 Main Street - Topsham, ME 04086

T: 207-837-6110

phoward@priorityrealestategroup.com