

# FOR LEASE • OFFICE/FLEX SUITE

506 Main Street • Westbrook, ME



**Mike Anderson**  
O 207.358.7028  
C 207.318.5969  
Mike@malonecb.com

## 2,089± SF OFFICE/FLEX

- One available suite in Stockhouse Station, a former historic mill that was fully renovated in 2006
- Successful multi-tenanted retail/office building in the center of Westbrook
- Located along Main Street with great visibility and close proximity to Portland and I-95
- Plenty of on-site parking

**LEASE RATE: \$10.00-\$12.00/SF NNN**



# PROPERTY SUMMARY

## 506 Main Street • Westbrook, ME



### Site Info

OWNER:	Stockhouse Station LLC
DEED:	Book 32869, Page 0171
ASSESSOR:	Map 40, Lot 164
LOT SIZE:	2.64± AC
SIGNAGE:	Pylon at street
PARKING:	Ample onsite



### Building Info

BUILDING SIZE:	24,768± SF
AVAILABLE SPACE:	Suite 24B : 2,089± RSF
YEAR BUILT:	1893; renovated in 2006
CONSTRUCTION:	Masonry
ROOF:	Flat rubber membrane
SIDING:	Brick
CEILING HEIGHT:	10'±
HVAC:	Forced hot air; Gas
UTILITIES:	Municipal water/sewer
RESTROOM:	Men & women's in common hallway
SPRINKLER:	Yes
NNN EXPENSES:	\$7.65/SF estimated



# FLOOR PLAN

506 Main Street • Westbrook, ME

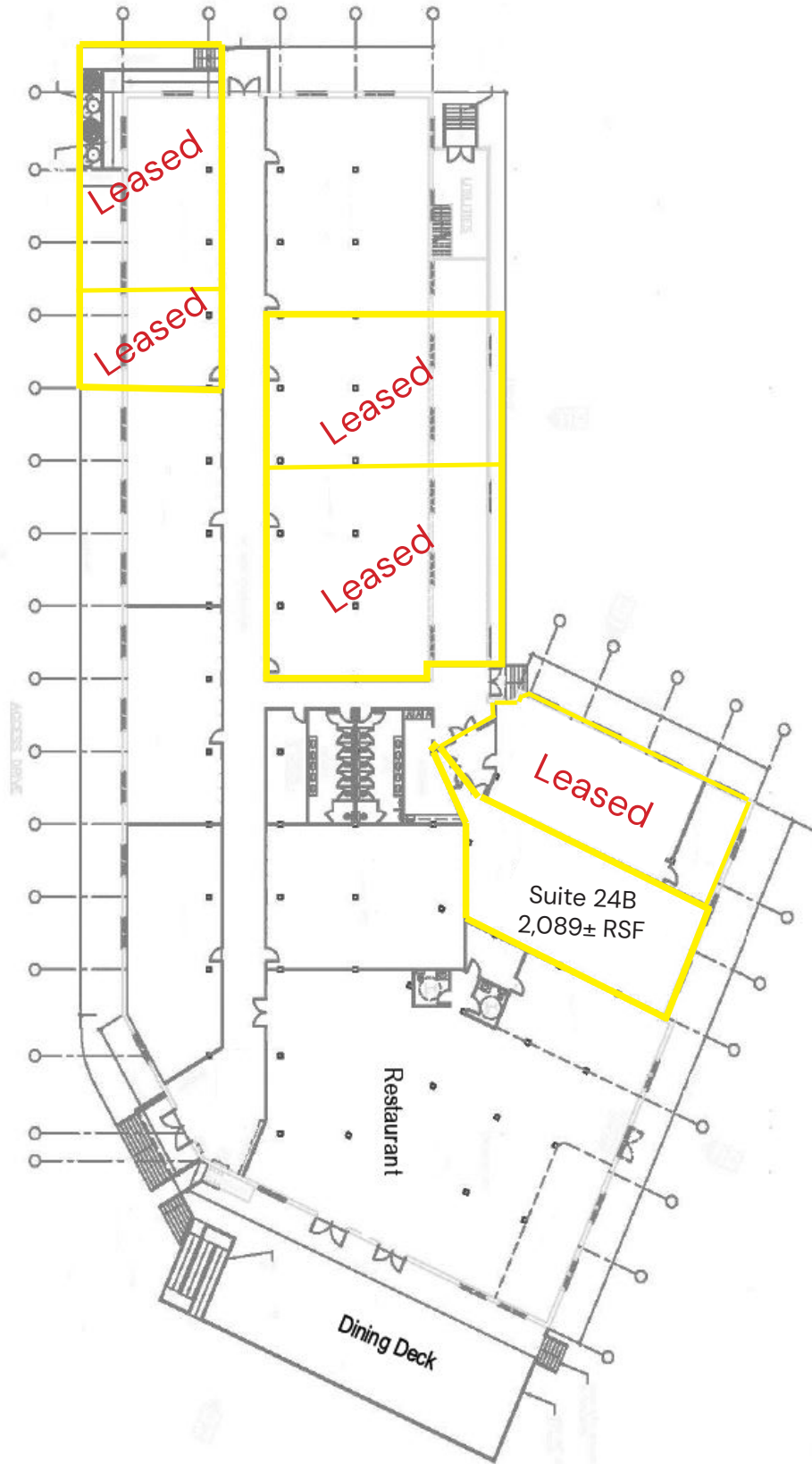

# LOCATION MAP

506 Main Street • Westbrook, ME

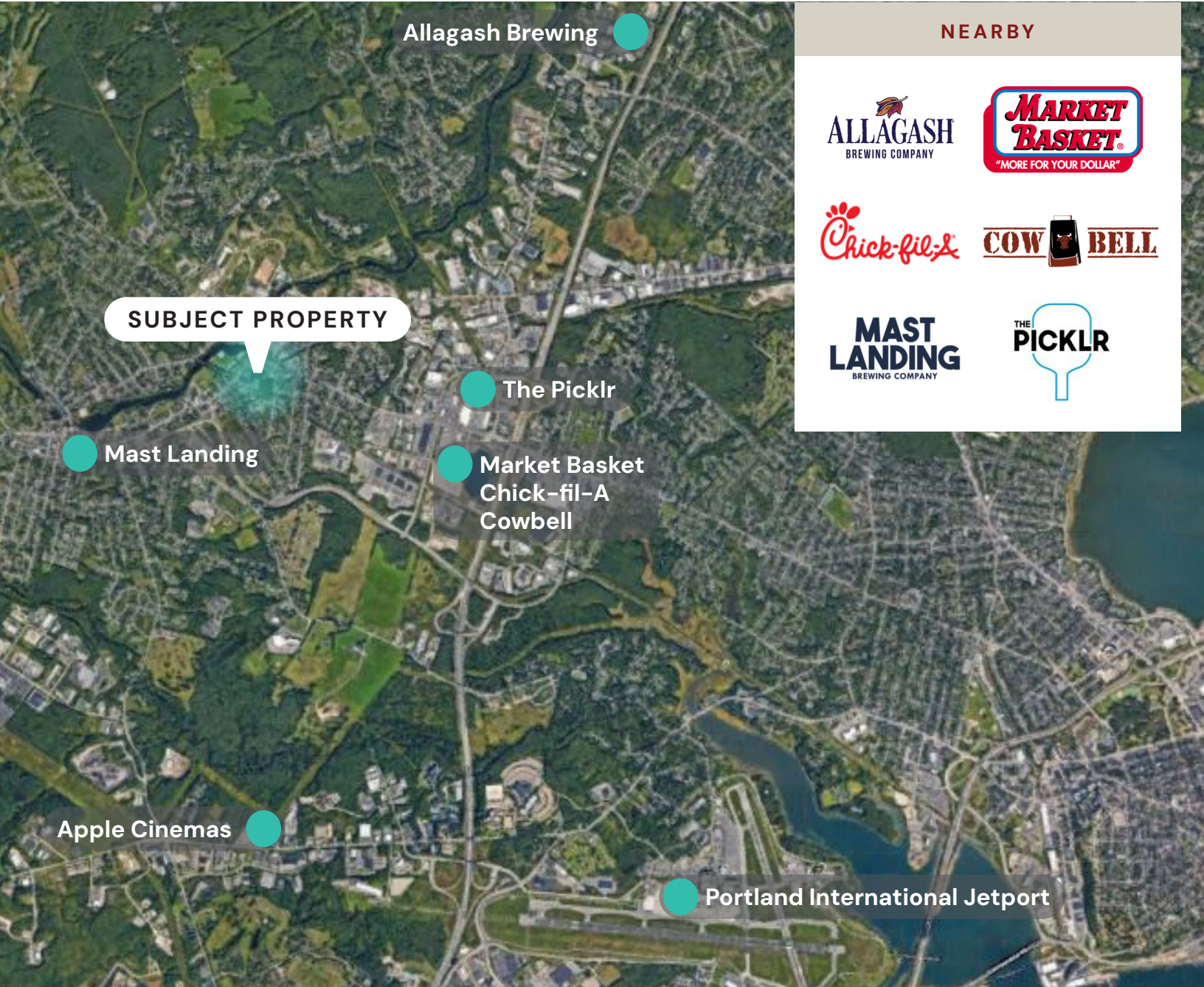

This document has been prepared by Malone Commercial Brokers for advertising and general information only. Malone Commercial Brokers makes no guarantees, representations or warranties of any kind, expressed or implied, regarding, but not limited to, warranties of content, accuracy, and reliability. Any interested party should undertake their own inquiries as to the accuracy of the information. Malone Commercial Brokers excludes unequivocally all informed or implied terms, conditions and warranties arising out of this document and excludes all liability for loss and damages there from. All data is subject to change of price, error, omissions, other conditions or withdrawal without notice. Malone Commercial Brokers is acting as the Seller's/Lessor's agent in the marketing of this property.