

Fully Approved Addition  
Expandable to Total of ± 22,631 SF



**PROPERTY DESCRIPTION**

Development Associates is pleased to offer For Lease +/- 15,583 Square Foot of Office/Industrial space with ample parking located in an established Industrial Park setting in Chicopee, MA.

Space ideal for Professional Office, Industrial, Assembly, Lab/Medical.

Fully approved addition - expandable to a total of 22,631 SF



**PROPERTY HIGHLIGHTS**

- Available for Immediate Occupancy
- Ample On-Site Parking
- Floor plan can be customized to suit your requirements.
- Close proximity to local amenities
- High Quality, Corporate Profile
- Conveniently located near Mass Pike and easy access to I-91 and other major highways.

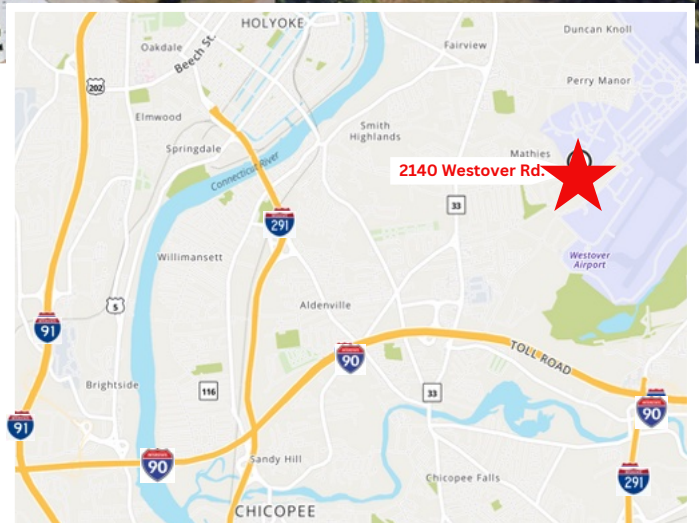

Developers and Brokers of Commercial Properties

200 Silver Street, Suite 201 | Agawam, MA 01001

DISCLOSURE: BROKER HAS A FINANCIAL INTEREST IN THIS PROPERTY.



**KEN VINCUNAS**  
Licensed Broker in MA  
(413) 789-3720

[kvincunas@devassociates.com](mailto:kvincunas@devassociates.com)

[www.Devassociates.com](http://www.Devassociates.com)

**EXISTING TOTAL SQUARE FOOTAGE: ± 15,583**  
**EXPANDABLE ADDITION: Up to ± 22,631 Total SF**

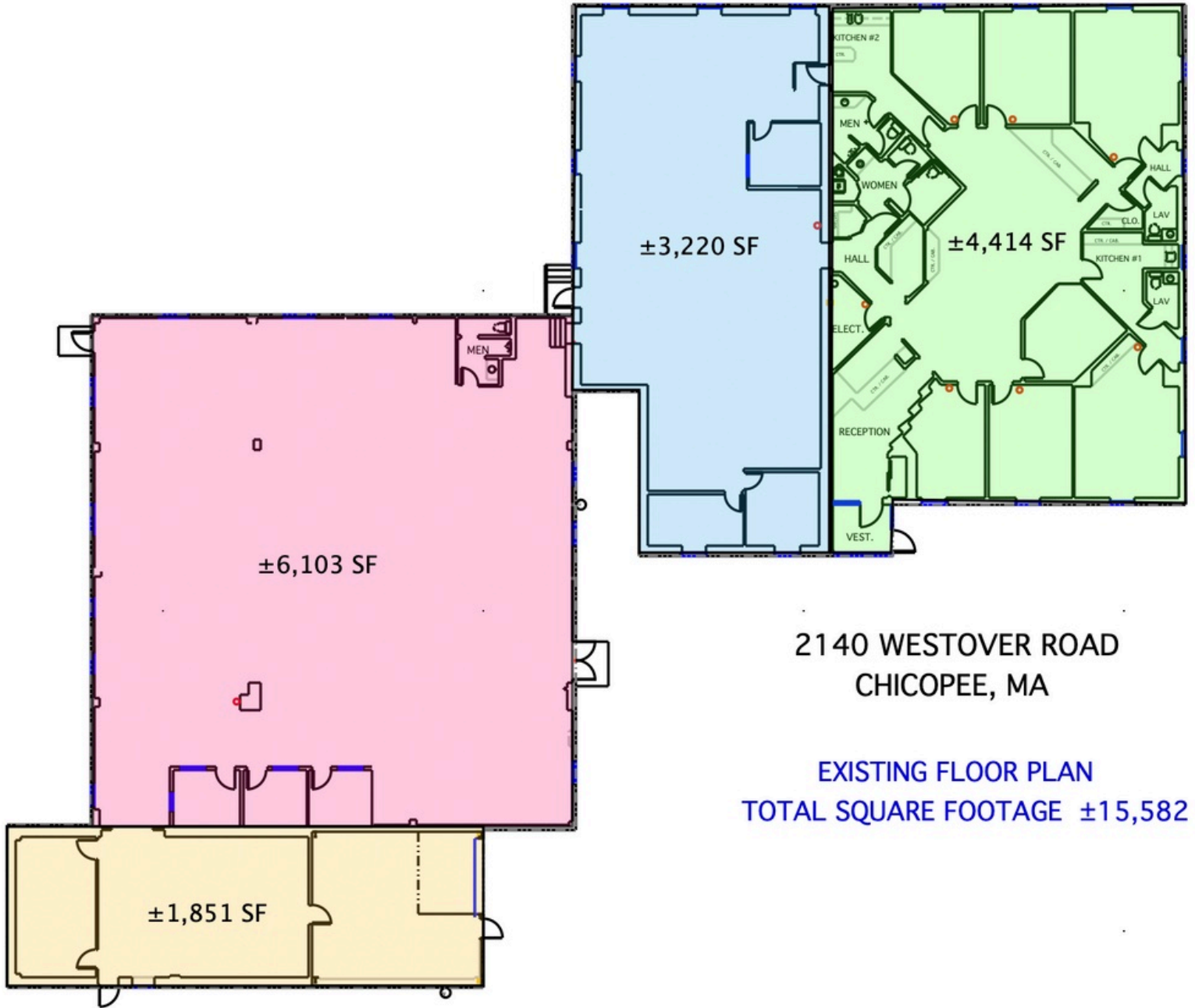

2140 WESTOVER ROAD  
CHICOPEE, MA

EXISTING FLOOR PLAN  
TOTAL SQUARE FOOTAGE ±15,582



Developers and Brokers of Commercial Properties

200 Silver Street, Suite 201 | Agawam, MA 01001

DISCLOSURE: BROKER HAS A FINANCIAL INTEREST IN THIS PROPERTY.



KEN VINCUNAS  
Licensed Broker in MA  
(413) 789-3720

[kvincunas@devassociates.com](mailto:kvincunas@devassociates.com)

[www.Devassociates.com](http://www.Devassociates.com)