

**PORTA
& CO.**

FOR LEASE | BAYSIDE MEDICAL OFFICE

165 - 175 Lancaster Street | Portland, ME



Property Highlights

- Office suites available
- New Ownership, fresh painting and carpeting
- Convenient location in Bayside with easy access to 295 and the Old Port
- Parking available at below Market Rates in the Public Market Garage
- Other Tenants include Baxter Academy, Goodwill, Opportunity Alliance, Maine Health and others
- Lease Rate : \$17.50/SF MG



PORTA & CO.

COMMERCIAL REAL ESTATE

30 Milk Street, Second Floor
Portland, ME 04101
207-747-1515
www.portacompany.com

Owner	Port Property
Lease Rate	\$17.50/SF Modified Gross
Utilities	Electric charged back, heat included
Parking Ratio	3/1000
Parking Rate	\$135/mo per space
Building Size	110,000 SF
Zoning	B6
Improvements	Paint and Flooring offered

Available Spaces

175 Lancaster - Suite 209	745± SF	Leased
175 Lancaster - Suite 216	3,584± SF	Leased
175 Lancaster - Suite 220A	2,100± SF**	Leased
175 Lancaster - Suite 221	1,900± SF**	Leased
175 Lancaster - Suite 218A- Available 11/30/2025	1,059± SF	
175 Lancaster - Suite 209- Available 03/31/2026	745± SF	
175 Lancaster - Suite 208D	368± SF - \$400/ Month MG	



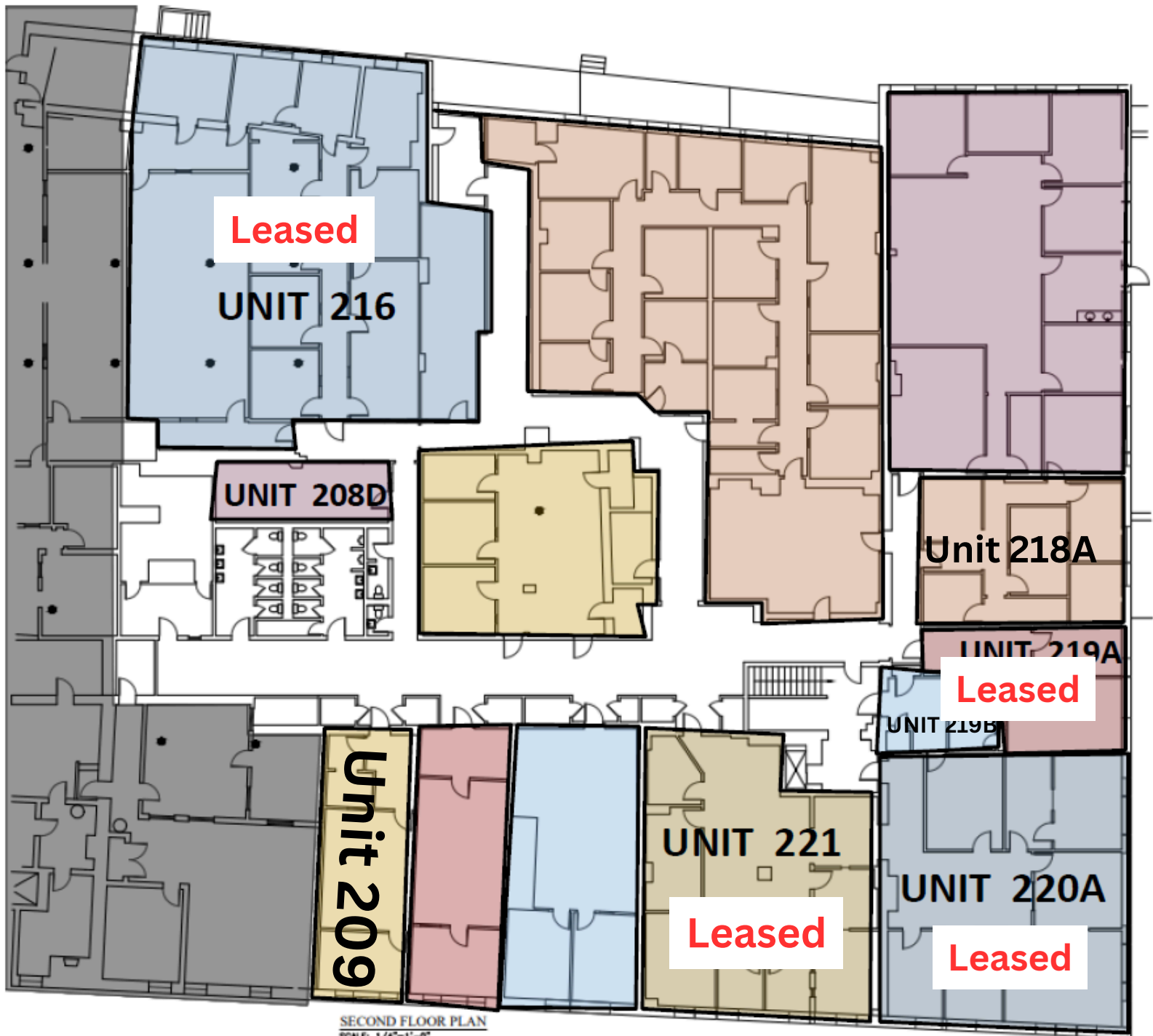

SECOND FLOOR PLAN
SCALE: 1/4"=1'-0"



CONTACT

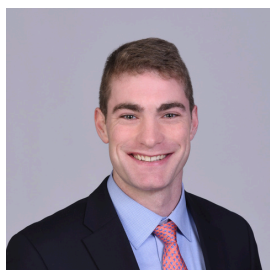

Peter Gwilym
 Broker
 C: 207-272-4262
 O: 207-558-0901
 pgwilym@portacompany.com



Emmett Peoples
 Associate Broker
 C: 207-400-4939
 O: 207-747-1515
 epeoples@portacompany.com

This information has been obtained from sources believed reliable and is intended for informational use only. The information contained herein has not been verified for accuracy or completeness. It is recommended that prospective tenants and buyers conduct their own inspection of the property and verify all information. Any reliance on this information is solely at your own risk. Photos herein are the property of their respective owners. Use of these images without the express written consent of the owner is prohibited.