

68 Jones Creek Drive, Pine Point, Scarborough

Ideal oversize lot for a new single-family
Impressive Nonesuch River frontage and views

For Sale

STATE OF MAINE "LINE OF TAKING" AS SHOWN ON PLAN REFERENCE 4.d. AND DESCRIBED IN PLAN REFERENCE 4.d. RECORDED IN THE CLUM COUNTY REGISTRY OF DEEDS.

Change of use of nonconforming structure (Ch. 405C, Sec. 12.C(5)) requires PB approval.

Relocating a structure (Sec. 12.C(3)) requires ZBA approval to meet greatest practical extent.

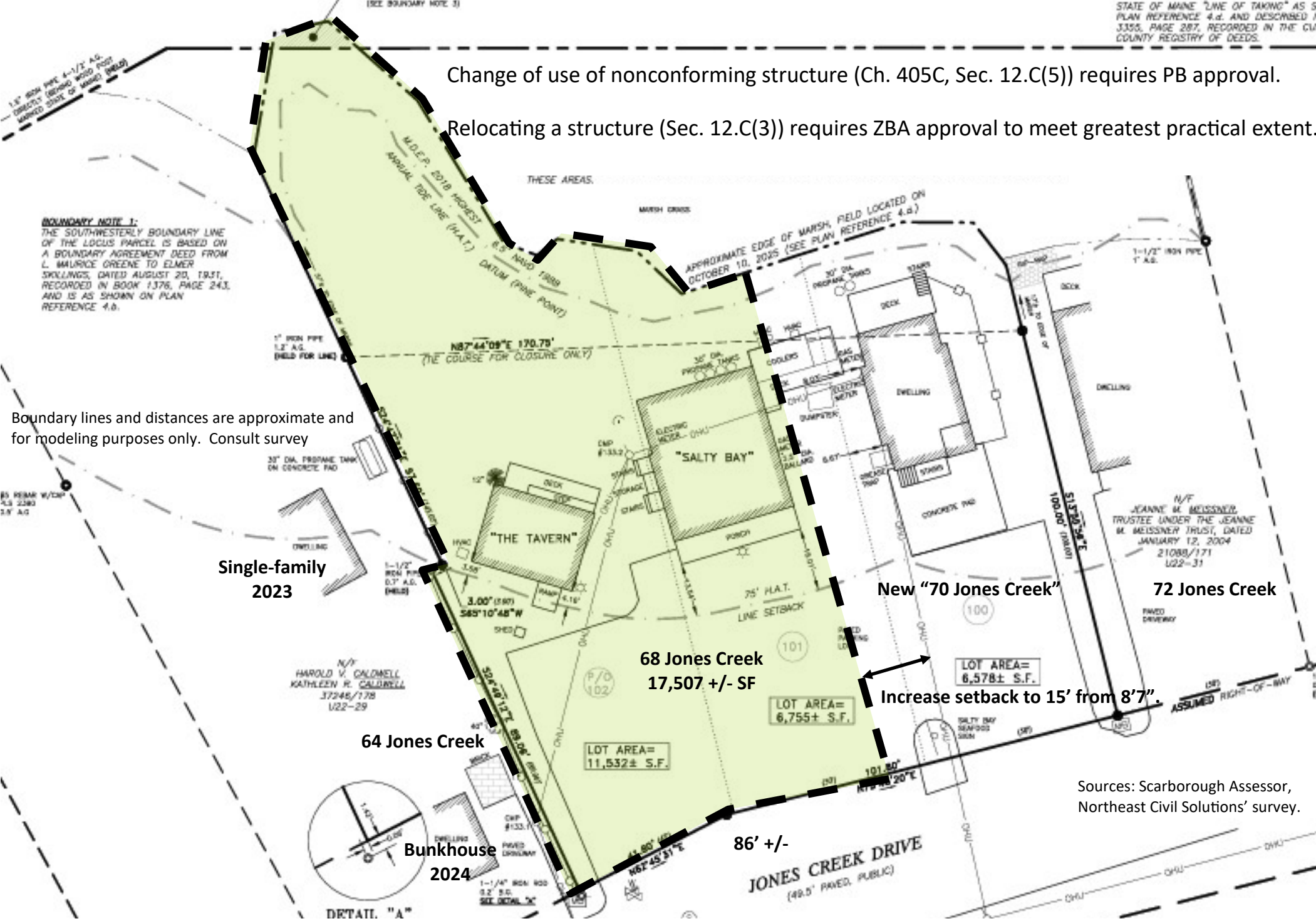

Boundary lines and distances are approximate and for modeling purposes only. Consult survey

Single-family
2023



Sources: Scarborough Assessor,
Northeast Civil Solutions' survey.