

# FOR LEASE • RETAIL/MULTIPURPOSE

1041 Brighton Avenue • Portland, ME



**Mike Anderson**  
O 207.358.7028  
C 207.318.5969  
Mike@malonecb.com

## 2,429± SF END-CAP UNIT

- Highly visible location with traffic counts of 25,000± cars/day on Brighton Avenue across from Lowes.
- Close proximity to Rock Row in Westbrook and I-95.
- Large pylon and building signage.
- Roll-up door in the back for easy loading.
- Open concept space providing flexibility for a variety of uses.
- New ceiling and lighting throughout

**LEASE RATE: \$16.00/SF NNN**

# PROPERTY SUMMARY

## 1041 Brighton Avenue • Portland, ME



### Site Info

OWNER:	All-American Family, LLC
DEED:	Book 35806, Page 119
ASSESSOR:	Map 274, Lot 1
LOT SIZE:	2.3± AC
SIGNAGE:	On building and pylon sign
PARKING:	Ample on-site
ZONING:	B2 - Business Community



### Building Info

BUILDING SIZE:	23,477± SF
AVAILABLE SPACE:	Suite 1: 2,429± SF
YEAR BUILT:	1988
CONSTRUCTION:	Steel frame
ELECTRICITY:	Separately metered
HVAC:	Gas-fired, rooftop units
UTILITIES:	Municipal water/sewer
RESTROOM:	Two (2)



### Current Tenants

- House of Cards
- Portland Smoke & Vape
- Gwani Styles Barbershop
- US Coast Guard Recruiting Office
- Sanctuary Tattoo
- Mayflower Spa
- La Tienda Latin Market
- Panda Garden Chinese Restaurant
- EZ Wash Laundromat
- Back in Motion



# TENANT MIX FLOOR PLAN

1041 Brighton Avenue • Portland, ME

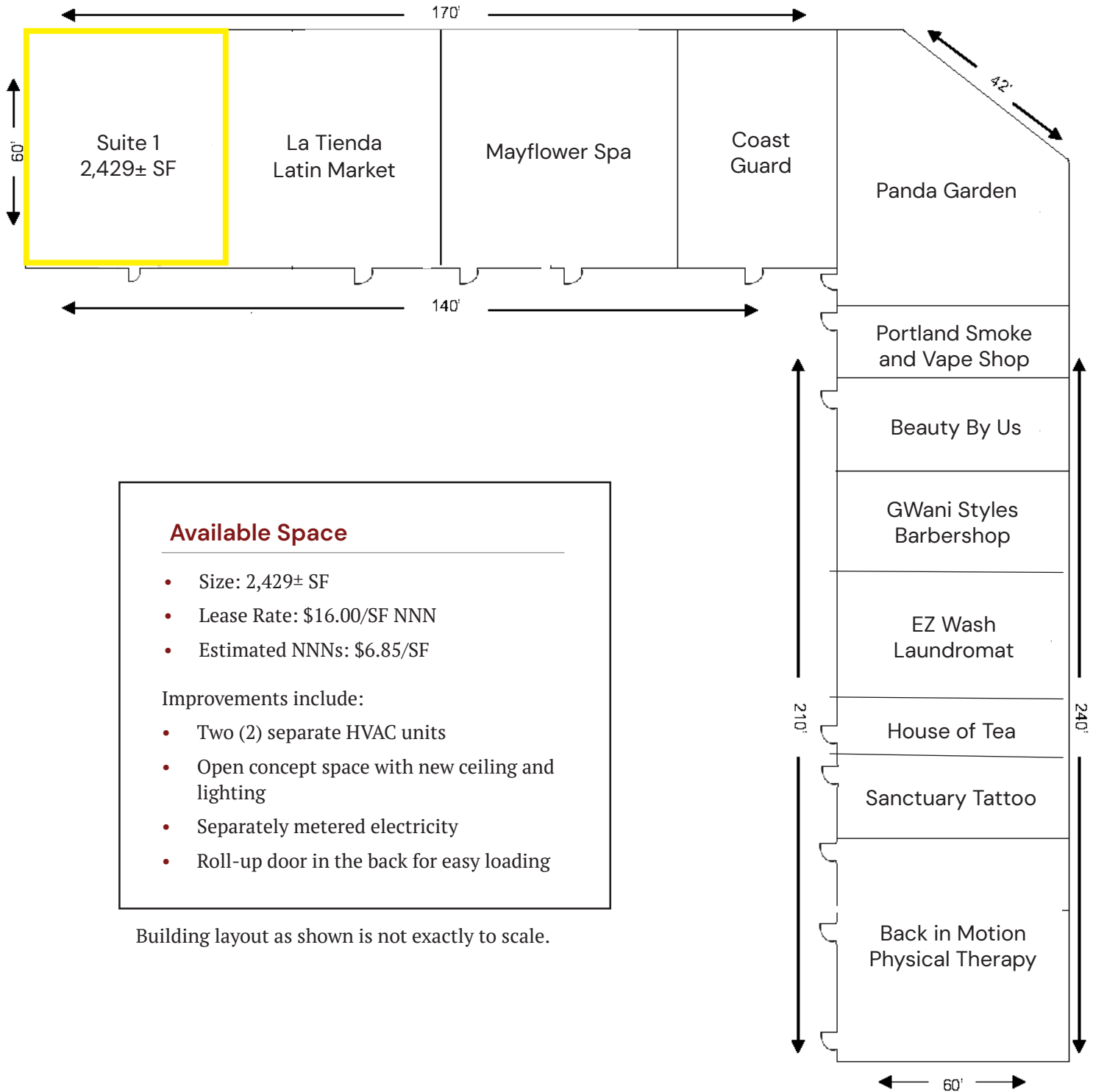

### Available Space

- Size: 2,429± SF
- Lease Rate: \$16.00/SF NNN
- Estimated NNNs: \$6.85/SF

### Improvements include:

- Two (2) separate HVAC units
- Open concept space with new ceiling and lighting
- Separately metered electricity
- Roll-up door in the back for easy loading

Building layout as shown is not exactly to scale.

# SUITE 1 FLOOR PLAN

1041 Brighton Avenue • Portland, ME

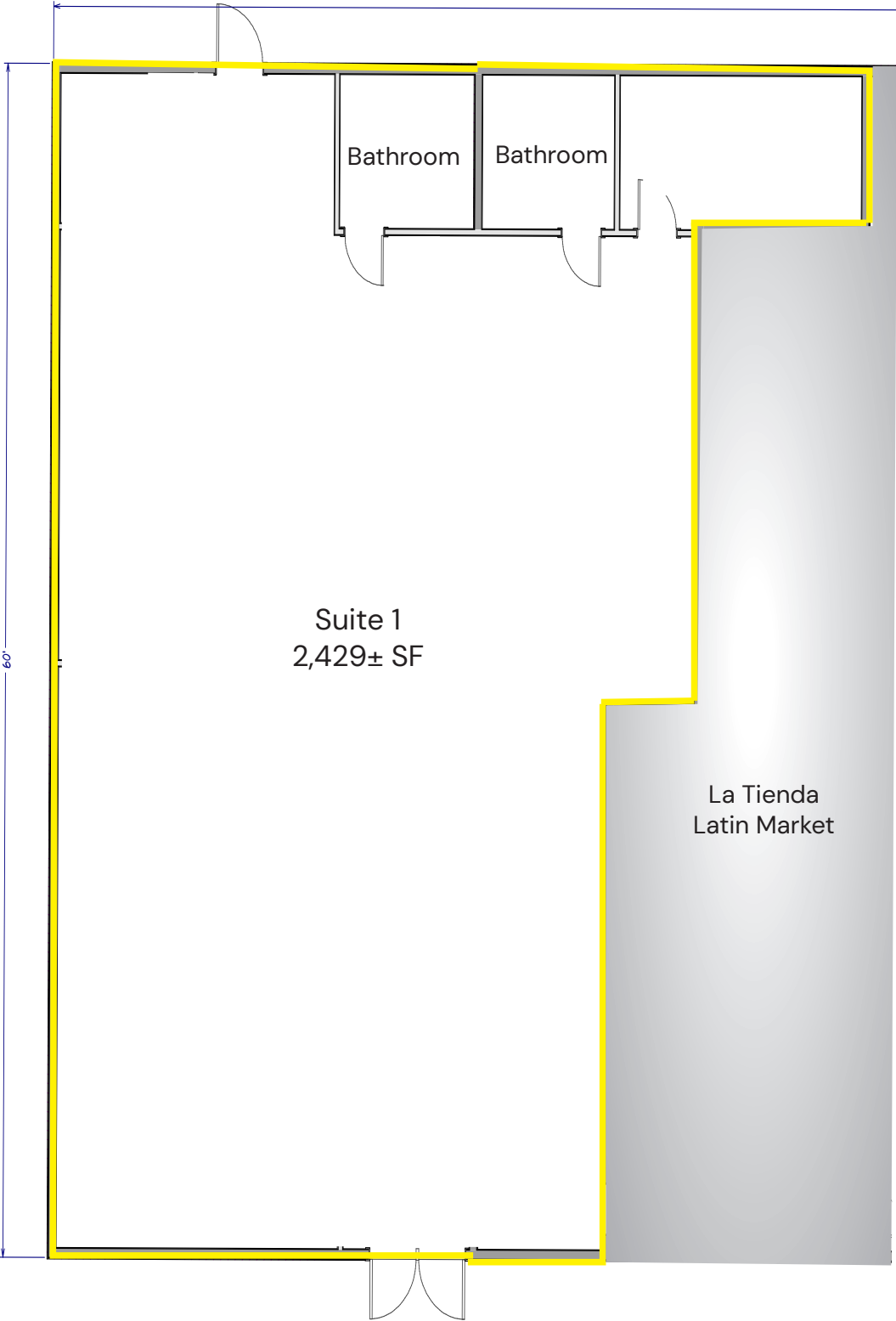

# 5-MILE DEMOGRAPHICS

1041 Brighton Avenue • Portland, ME



123,191  
Population

57,042  
Homes

2.1  
Average Household Size

40  
Average Age



8,501  
Total Businesses

127,640  
Total Employees



\$91,814  
Average Household  
Income

## Education

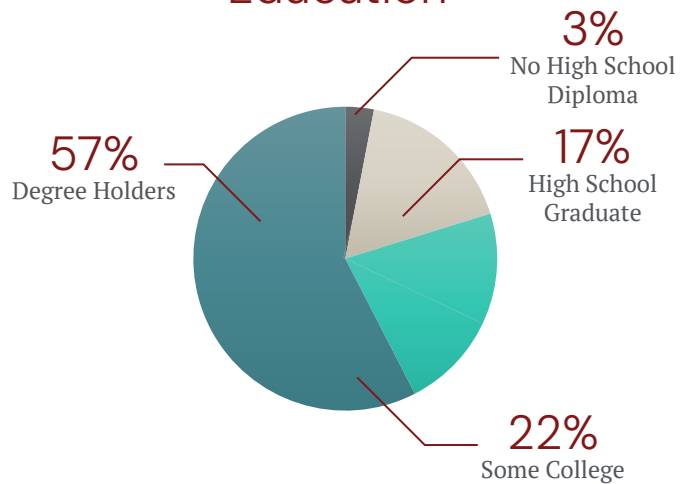

## Employment

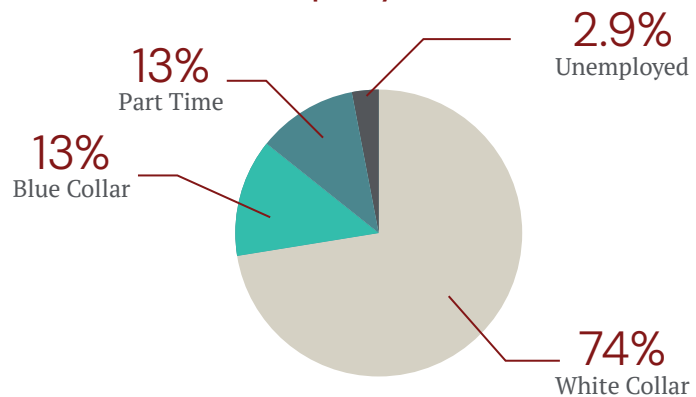

# LOCATION MAP

1041 Brighton Avenue • Portland, ME



This document has been prepared by Malone Commercial Brokers for advertising and general information only. Malone Commercial Brokers makes no guarantees, representations or warranties of any kind, expressed or implied, regarding, but not limited to, warranties of content, accuracy, and reliability. Any interested party should undertake their own inquiries as to the accuracy of the information. Malone Commercial Brokers excludes unequivocally all informed or implied terms, conditions and warranties arising out of this document and excludes all liability for loss and damages there from. All data is subject to change of price, error, omissions, other conditions or withdrawal without notice. Malone Commercial Brokers is acting as the Seller's/Lessor's agent in the marketing of this property.