

FOR LEASE | HARBOR PLAZA

235 CAMDEN ST, ROCKLAND, ME



PROPERTY OVERVIEW

SHOPPING PLAZA

Harbor Plaza was developed in 1987 as the premier shopping center in the Midcoast. Today, the center is home to several strong national tenants, including Rent-A-Center, Olympia Sports, H&R Block, Label Shopper, and the UPS Store, and is anchored by Shaws, Staples, and TJ Maxx/HomeGoods.

Harbor Plaza is the go-to shopping mall for both local residents and the massive influx of tourists Midcoast Maine sees in the summertime. High foot traffic between stores providing excellent in-line store business.

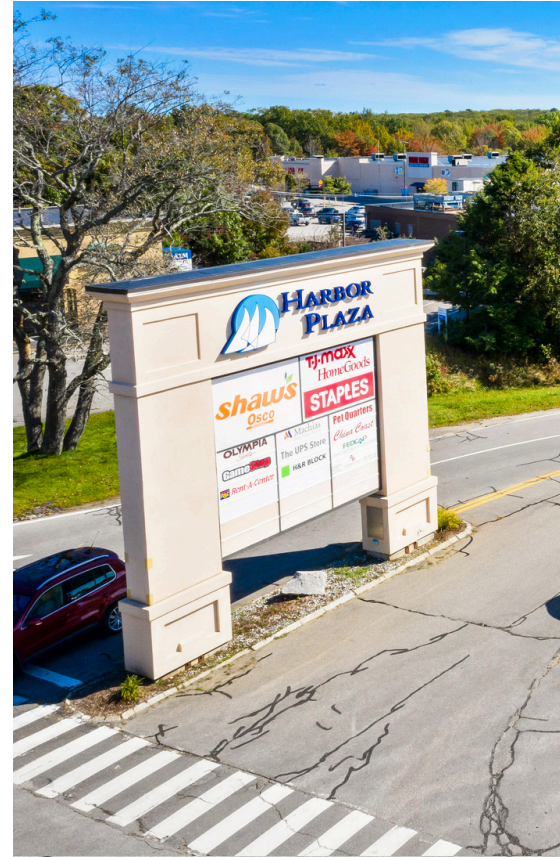

CoreFirms.com
16 Casco Street
Portland, ME 04101

Contact Charlie Hippler
(207) 744-3084 Ext 315
Charlie@CoreFirms.com

FOR LEASE | HARBOR PLAZA

235 CAMDEN ST, ROCKLAND, ME



PROPERTY DETAILS

LEASE RATES

7,450 SF	\$14.00 PSF
5,700 SF	\$14.00 PSF
4,300 SF	\$11.00 PSF
4,561 SF	\$11.00 PSF
2,040 SF	\$15.00 PSF
1,740 SF	\$16.00 PSF

LEASE TYPE	NNN
EST. CAM	\$3.85 PSF (Includes Property Taxes)

LOT SIZE	17.4 ± Acres
SQ. FOOTAGE	179,969 ± SF
ROAD FRONTAGE	669' ± on Camden St
YEAR BUILT	1987
ZONING	Commercial

HEAT TYPE	Propane
HEAT SOURCE	Central
AIR CONDITIONING	Package Unit

PARKING SPACES	704 (4.17 spaces / 1,000 SF)
----------------	------------------------------

DEVELOPMENT	Outparcel Development Available
-------------	------------------------------------



CoreFirms.com
16 Casco Street
Portland, ME 04101

Contact Charlie Hippler
(207) 744-3084 Ext 315
Charlie@CoreFirms.com

FOR LEASE | HARBOR PLAZA

235 CAMDEN ST, ROCKLAND, ME



PLAN VIEW

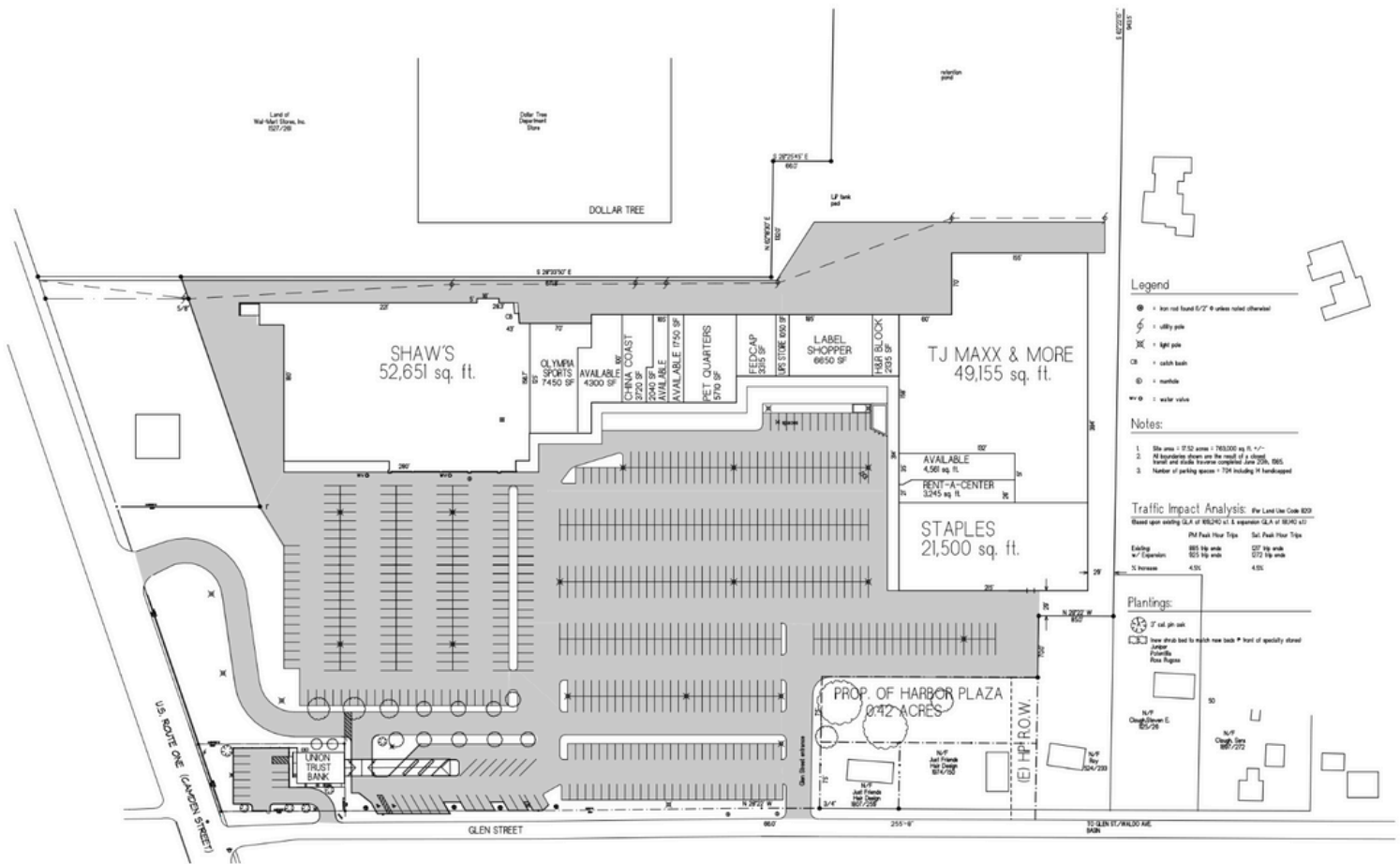

HARBOR PLAZA

235 CAMDEN STREET, ROCKLAND, MAINE

SCALE: 1"=100'



FOR LEASE | HARBOR PLAZA

235 CAMDEN ST, ROCKLAND, ME



MAP

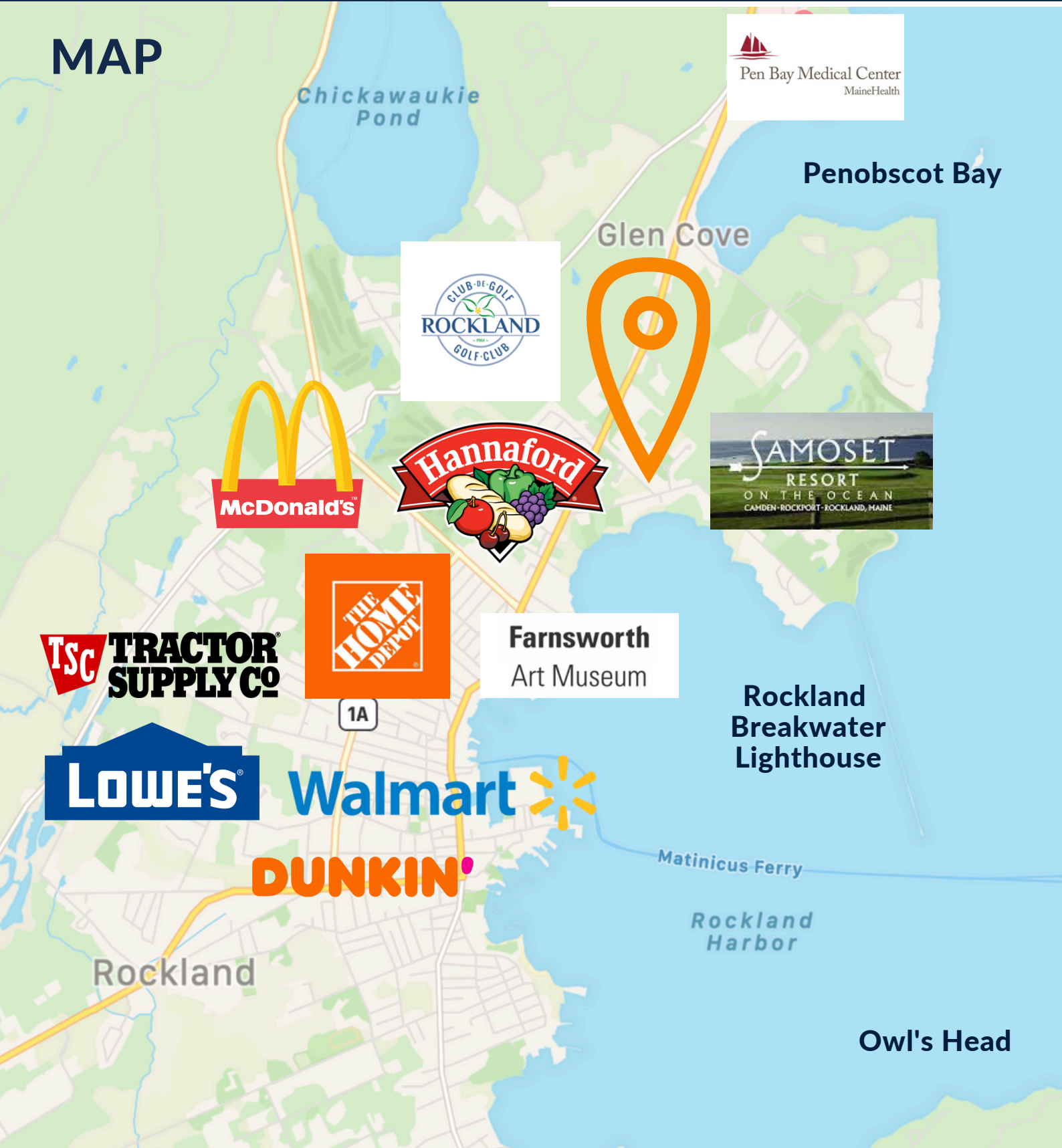

CORE
CoreFirms.com
16 Casco Street
Portland, ME 04101

Contact **Charlie Hippler**
(207) 744-3084 Ext 315
Charlie@CoreFirms.com

FOR LEASE | HARBOR PLAZA

235 CAMDEN ST, ROCKLAND, ME



CONTACT



Charlie Hippler
Associate Broker
(207) 530-2708
Charlie@CoreFirms.com

KNOX COUNTY DEMOGRAPHICS

POPULATION	39.8k
HIGHER EDUCATION	34.2%
MEDIAN AGE	48.6
MALE	49.4%
FEMALE	50.6%
MEDIAN HOUSEHOLD INCOME	\$57.8k
MEDIAN PROPERTY VALUE	\$209.9k



Josh Soley
President
(207) 744-3084 ext 301
Josh@CoreFirms.com