

FOR LEASE

20 East Avenue

LEWISTON - MAINE

18,040 sf available
 17,239 sf (subdividable)
 6,145 sf restaurant space

PROPERTY DESCRIPTION

250,000 SF shopping center anchored by Hannaford
 delete this line

Located at the intersection of East Avenue and Libson Street with a traffic count of ~24,000

retailers include: CVS, Bull Moose Music, O'Reilly Auto Parts, Family Dollar, Art's Nails, SplittN' Wood, Fun City and Sea40

Available Space: ~3,000sf-18,040sf

PROPERTY PHOTO

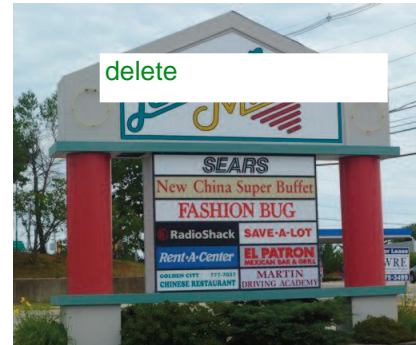

PROPERTY AERIAL



CONTACT INFORMATION



795 Roosevelt Trail - Windham, ME 04062
 Jay Wise - O: 207.775.3499 - C: 207.329.3499
 jaywise@wrebrokers.com - www.wrebrokers.com

FOR LEASE 20 East Avenue LEWISTON - MAINE

960 SF - 89,572 SF LEWISTON MALL

PROPERTY SITE PLAN

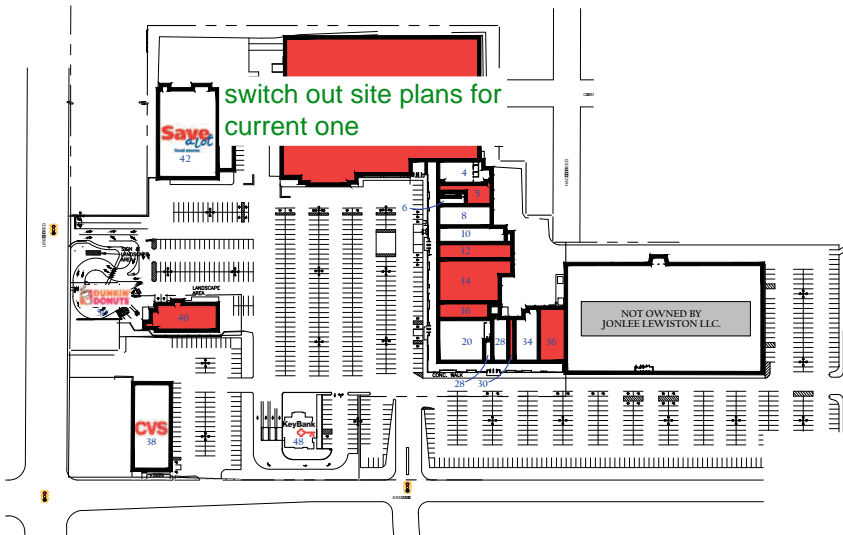

2	Available	89,572 SF
4	Rent-A-Center	4,345 SF
5	Available	2,630 SF
6	Arts Nails	900 SF
8	Bull Moose Music	4,000 SF
10	Olympia Sports	3,750 SF
12	Available	4,200 SF
14	Available	9,800 SF
16	Available	2,950 SF
20	Kennel Shop	7,400 SF
26	Martin Driving School	500 SF
28	Radio Shack	2,563 SF
30	Available	960 SF
34	NTI Technical School	4,000 SF
36	Available	5,000 SF
38	CVS	11,200 SF
40	Available	6,145 SF
42	Save-A-Lot	18,040 SF
44	Golden City	2,400 SF
48	Key Bank	3,336 SF
50	Dunkin Donuts	

PROPERTY MAP



PROPERTY SPECIFICATIONS

Space Available 3,000-18,040sf SF
 Rental Rate \$12-\$18.00 psf NNN
 { delete
 f

DEMOGRAPHICS

	1 Mile	3 Mile	5 Mile
Po	I'll shoot new demos		58,862
Da			46,558
# c			26,205
Average HH Income	\$50,528	\$54,733	\$57,232

WRE Commercial Brokers, is representing the Seller in the marketing, negotiation, and sale and/or lease of this property. While information furnished is from sources deemed reliable, no warranty or representation, express or implied, is made as to the accuracy of information contained herein, and same is submitted subject to errors, omissions, change of price, rental or other conditions, withdrawal without notice, and to any special listing conditions imposed by our principals.

CONTACT INFORMATION



795 Roosevelt Trail - Windham, ME 04062

just use the cell and let's use
 jay@wrebrokers.com

C: 207.329.3499

www.wrebrokers.com